

DO NOT SCALE

Millimetres

0 10 100

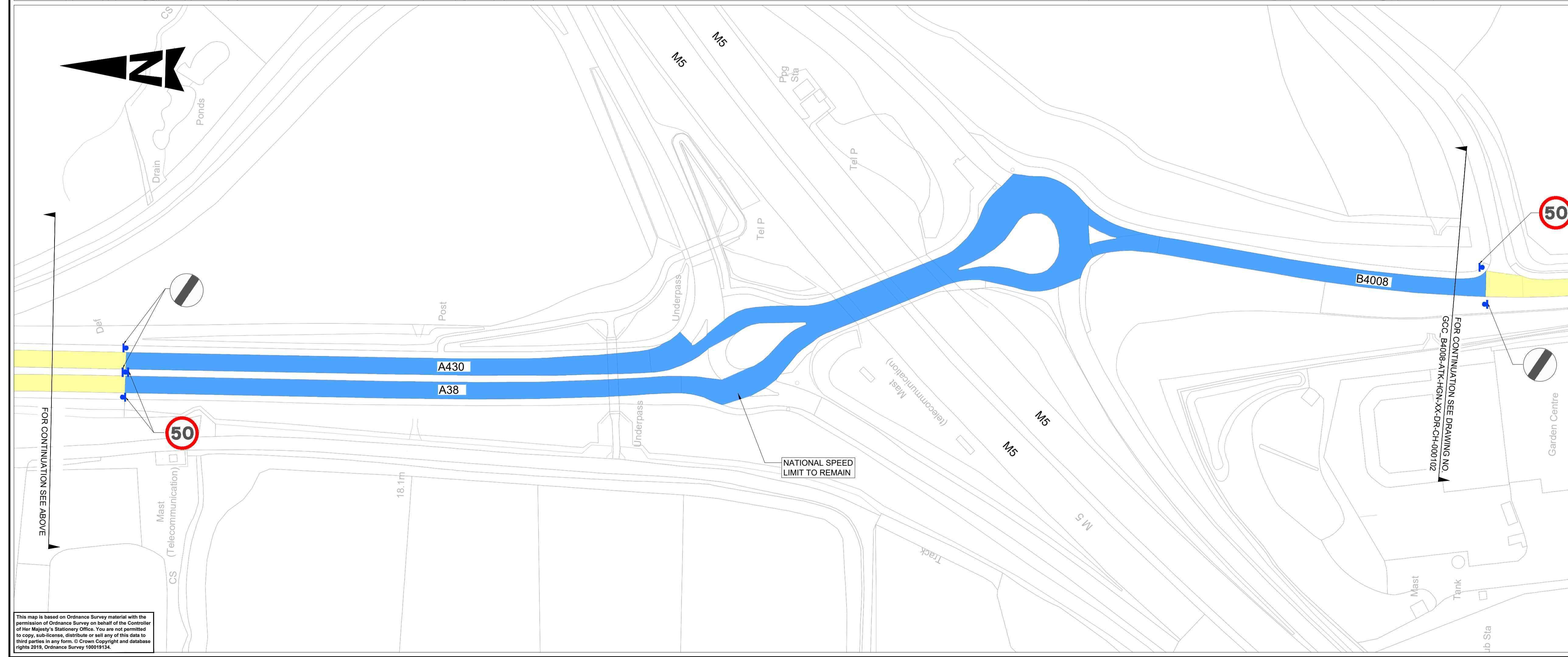
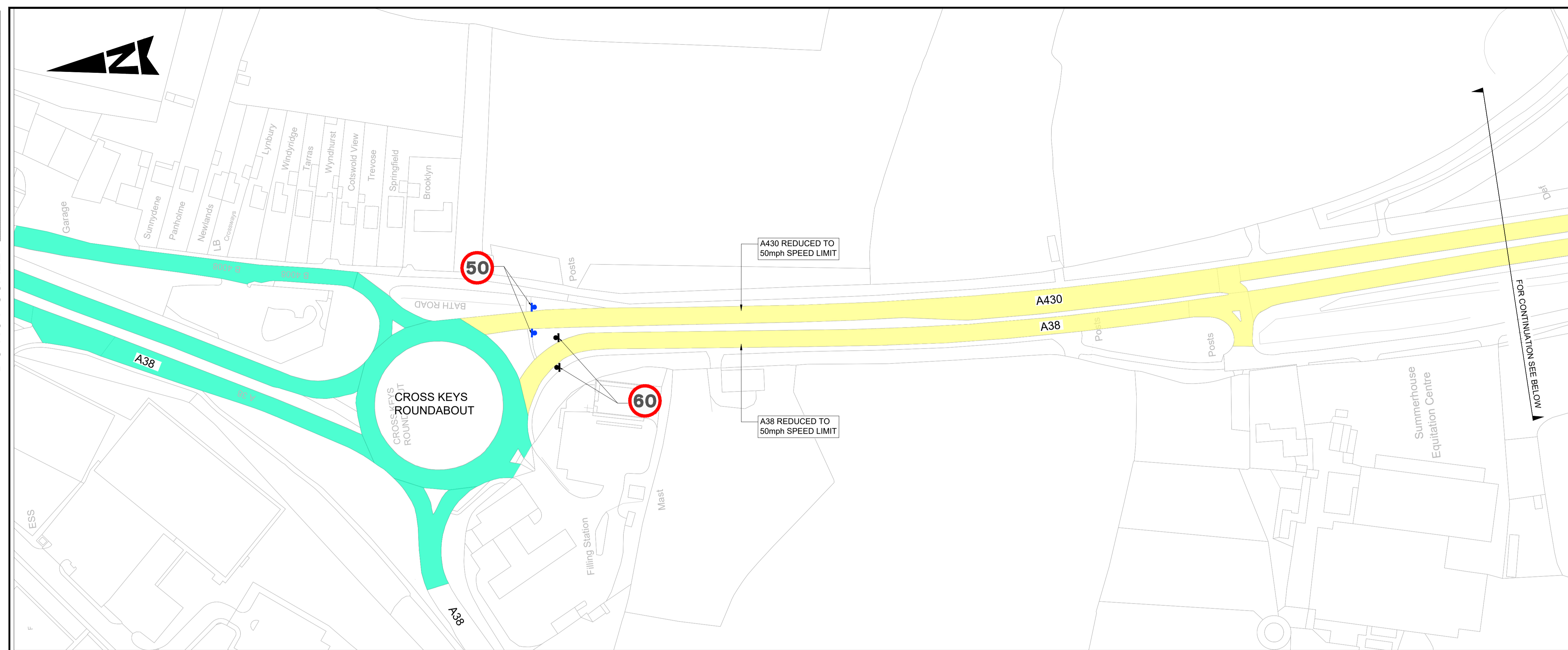

NOTES:
 1. DO NOT SCALE FROM THIS DRAWING.
 2. ALL DIMENSIONS ARE IN METRES UNLESS OTHERWISE STATED.

KEY

	NATIONAL SPEED LIMIT TO REMAIN.
	PROPOSED 50mph SPEED LIMIT.
	NOT BEING CHANGED AS PART OF THIS PROPOSAL.
	PROPOSED REGULATORY SIGN.
	EXISTING REGULATORY SIGN.

SAFETY, HEALTH AND ENVIRONMENTAL INFORMATION

In addition to the hazards/risks normally associated with the types of work detailed on this drawing, note the following significant residual risks (Reference shall also be made to the design hazard log).

Construction	NA
Maintenance / Cleaning	NA
Use	NA
Decommissioning / Demolition	NA

Description	Status	Revision	Drawn	Checked	Reviewed	Authorised	Issue Date
AMENDED AS PER TRO TEAM COMMENTS.	S0	P04	MC	RS	APC	ATP	23/01/23
AMENDED INCLUDING PHASE 1 ONLY	S0	P03	MC	RS	APC	AJP	13/10/22
AMENDED INCLUDING REVISED NORTHERN LIMITS	S0	P02	MC	RS	APC	AJP	12/01/22
FOR INFORMATION	S0	P01	FK	RS	APC	AJP	08/06/21

FOR INFORMATION S0

SNC-LAVALIN
ATKINS
 Member of the SNC-Lavalin Group
 Copyright © SNC Lavalin (2019) www.atkinsglobal.com

5th Floor, Block 5
 Shire Hall
 Bearland
 Gloucester
 GL1 2TH
 Tel : 08000 514514

Gloucestershire
 COUNTY COUNCIL

Project Title
A38/ A430/ B4008 BATH ROAD, GLOUCESTER.

Drawing Title
A38, A430 & B4008 PROPOSED 50mph SPEED LIMIT EXTENSION - PHASE 1 TRO DRAWING. (PLAN 1 OF 2)

Drawing Number	Project	Originator	Volume
GCC_B4008 - ATK - HGN - XX			
Location	Project Ref. No.	Sheet	Rev.
A1	B4008	1 of 2	P04

This map is based on Ordnance Survey material with the permission of Ordnance Survey on behalf of the Controller of Her Majesty's Stationery Office. You are not permitted to copy, sub-license, distribute or sell any of this data to third parties in any form. © Crown Copyright and database rights 2019, Ordnance Survey 100019134.